

REVISIONS			
REV.	DESCRIPTION	DATE	REVISED BY
A			

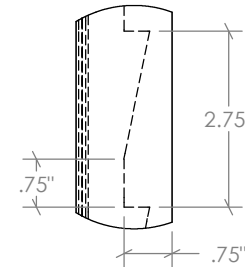

DETAIL A
SCALE 1 : 3

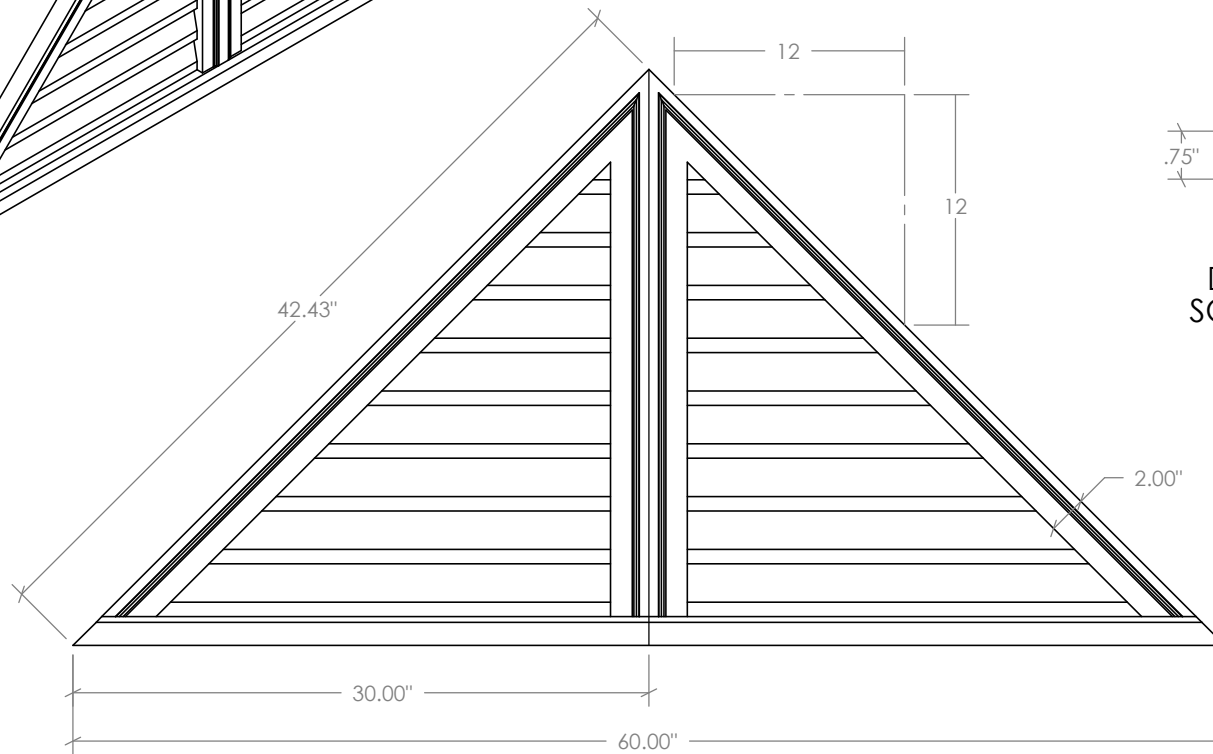
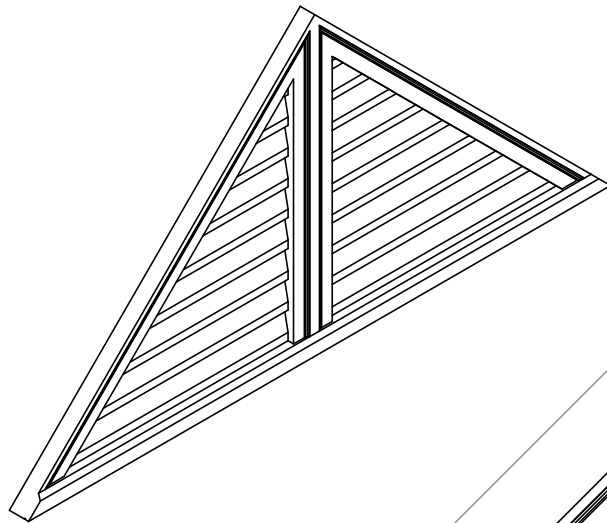
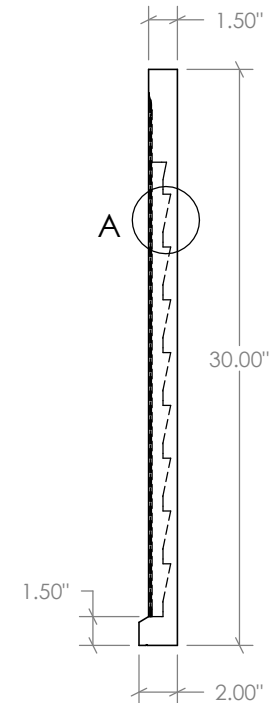

Tolerances		Tolerances	
0-24" ±	40-48" ±	000-610 ±	1017-1219 ±
1/32"	5/64"	1.0mm	2.0mm
24-32" ±	48-60" ±	611-813 ±	1220-1514 ±
3/64"	3/32"	1.3mm	2.5mm
32-40" ±	60-70" ±	814-1016 ±	1515-1778 ±
1/16"	1/8"	1.6mm	3.2mm

NU-WOOD™

SYNTHETIC ARCHITECTURAL MILLWORK

As manufactured by Jasper Plastics

501 W Railroad Ave. Syracuse, IN 46567

Office: 574-457-2062 sales@nu-wood.com

COPYRIGHT 2018 NU-WOOD ALL RIGHTS RESERVED



Description: NW LV-TRI60LR-12/12

Drawn by: RSAGRE

Item No.: 319132056

Date: 11/18/2024

Created: 05/22/2019

Vol.: 862.15 in³

Scale: 1 : 10