

| | | | |
|------|--------------|-------------|-------|
| REV: | DESCRIPTION: | REVISED BY: | DATE: |
| A | | | |

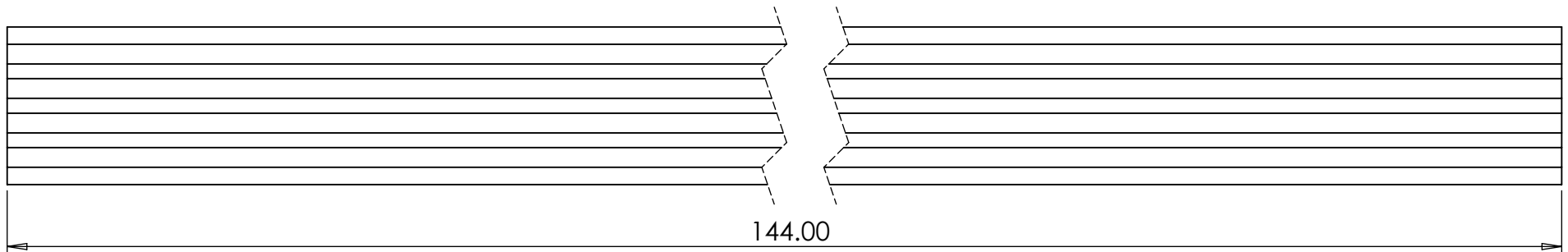

| Tolerances | | Tolerances | |
|------------|----------|------------|-------------|
| 0-24" ± | 40-48" ± | 000-610 ± | 1017-1219 ± |
| 1/32" | 5/64" | 1.0mm | 2.0mm |
| 24-32" ± | 48-60" ± | 611-813 ± | 1220-1514 ± |
| 3/64" | 3/32" | 1.3mm | 2.5mm |
| 32-40" ± | 60-70" ± | 814-1016 ± | 1515-1778 ± |
| 1/16" | 1/8" | 1.6mm | 3.2mm |

NU-WOODTM
SYNTHETIC ARCHITECTURAL MILLWORK

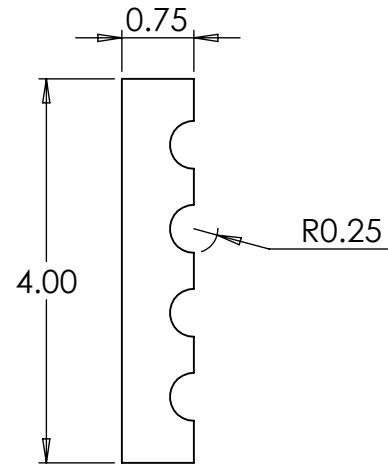

Nu-Wood by Jasper Plastics

501 W Railroad Ave Syracuse, In 46567

574-534-1192 O. 253-595-3715 F. sales@nuwood.com

COPYRIGHT 2018 NU-WOOD ALL RIGHTS RESERVED

DESCRIPTION: NW M409-12

Drawn by:
JRODES

ITEM NO.: 319170279

Date: 12/20/2018
Created: 12/20/2018

Volume: 375.45

Scale: 1:4